

90° FLAT SHUTTER VALVE "TALUR 130" SERIE

DIMENSIONS

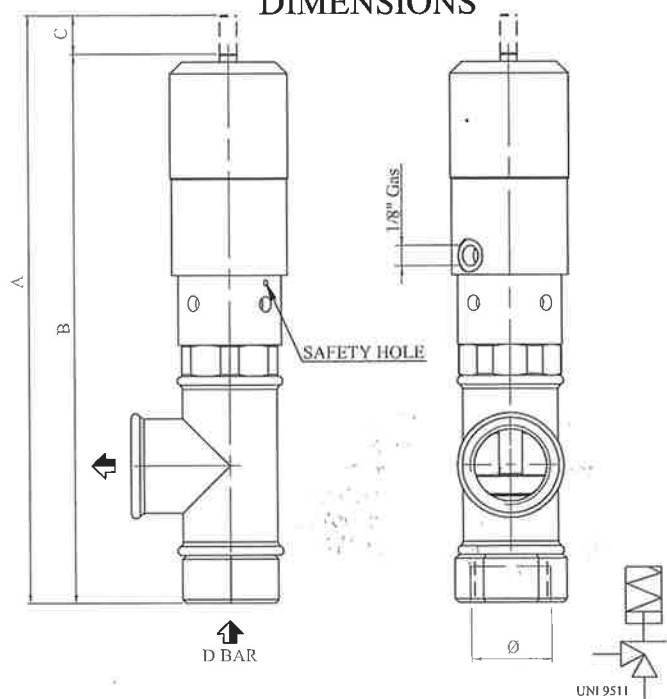

Maintenance manual

Application field

This valve can be used to intercept fluids and gas compatible with the valve material containing also dust as the rubber gaskets grant the seal. Please refer to the technical features **"Materials in contact with the product"**. The valve has a watertight seal on the upper part with indicator signalling an "open or close" status. The valve has a small tank filled with oil and a scraper to lubricate and protect the O-Ring from possible solid residuals. The valve is used where there is an angle connection at 90° in the pipe avoiding using an elbow.

Installation

To make the installation easier, please remove the actuator. Pack the threading between the sleeve and the fitting "please refer to spare parts". Connect the body valve on pipes with external threadings "please refer to dimensions D BAR". Screw the actuator being careful to insert the given O-Ring, manually close or do not exceed the 8 Nm tightening. Connect the working pressure in the proper threading of 1/8" Gas please refer to 1/8" Gas dimensions. The valve threadings are only for what above described. We advise to pack the threadings with liquid packing, or using gaskets so that to avoid an excessive stress on the threadings when closing. Please avoid positioning the valve with the knob downwards so that to prevent solid sediments stagnations in contact with the gaskets.

Maintenance

The valve has a safety hole signalling the possible bad functioning of the gaskets separating the actuator from the intercepted products. Please check the efficiency of these O-Rings through the above-mentioned hole every 3000/4000 operations. If necessary, please proceed to replace them, please refer to the spare parts **"gaskets Kit"**. **⚠**In case of maintenance, please pay attention when opening the cylinder as there is a **compressed spring** inside. Be sure the valve is lubricated by the pneumatic system.

Technical features

Shutter type: Flat shutter
Threading: GAS 55° UNI - ISO 228
Room temperature range: Min. 0°C; max. 100°C
Actuator working pressure range: Min. 5 bar; max. 10 bar
Actuator: Single acting normally close
Cylinder material: Alluminum 2011 alloy anodized
Shaft material: Stainless steel AISI 303
Valve body material: Brass OT-58 and zinc plated cast iron
Shutter material: Viton
Materials in contact with the product: Brass OT-58, P.T.F.E., AISI 303, Viton and zinc plated cast iron.

COD.	Ø	DIMENSIONS							Weight Kg
		A	B	C	D	E	F	G	
1838	1/2"	227	211	16	MAX 9				0.73
1977	3/4"	240	217	23	MAX 3				0.91
1976	1"	256	228	28	MAX 3				1.10
2018	1"1/4	272	245	27	MAX 3				1.66
2139	2"	341	307	34	MAX 3				2.57

SPARE PARTS

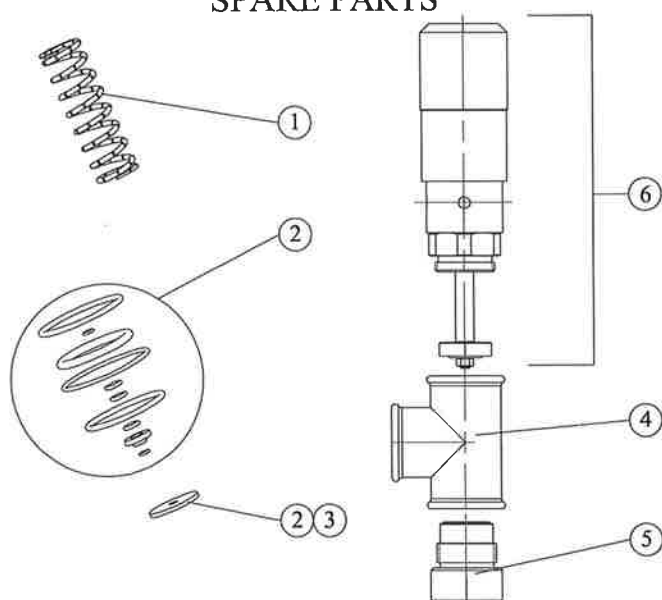

POS.	DESCRIPTION	SPARE PARTS CODE FOR SIZE							
		1/2"	3/4"	1"	1"1/4	1"1/2	2"	2"1/2	3"
1	SPRING	184	184	361	361		174		
2	GASKETS KIT	1840	1657	1553	1552		1557		
3	GASKET	824	646	647	648		650		
4	FITTING	931	751	744	746		753		
5	SLEEVE	927	754	745	747		756		
6	ACTUATOR	1839	1606	1433	1434		1383		